



MILLWORK

PRODUCT CATALOG



LOCATIONS

CMPC USA HEADQUARTERS

1040 CROWN POINTE PKWY., SUITE 950
ATLANTA, GA 30338
(770) 551-2640

POWELL VALLEY MILLWORK MAIN OFFICE & CLAY CITY MANUFACTURING SITE

588 LOFTY HEIGHTS RD.
CLAY CITY, KY 40312
(606) 663-9663

POWELL VALLEY MILLWORK

JEFFERSONVILLE MANUFACTURING SITE
7755 MAIN ST.
JEFFERSONVILLE, KY 40337

CONTENTS

THIS IS CMPC 3

OUR PURPOSE
FOREST HERITAGE
NURSERIES
FOREST MANAGEMENT

CMPC WOOD PRODUCTS 8

PLANTS
MILLWORK

PRODUCTS 11

TRIMBOARDS
MOULDINGS

- CASINGS
- BASE BOARDS
- CROWNS

ATTRIBUTES & MAIN USES
SPECIALTIES

- SHIPLAP
- EDGE & CENTER
- TREATED TRIMBOARD
- NICKEL GAP

NEW MILESTONES 29

POWELL VALLEY MILLWORK
POPLAR
PRODUCTS

FAQ 34

THIS IS
CMPC

FROM OUR
FIBER TO
THE WORLD

Our Purpose

Based on innovation, transformation, and sustainability in its business transactions, CMPC creates sustainable solutions from natural fibers for millions of people through its industrial and commercial operations in 12 countries.

To fulfill this purpose, all CMPC members guide their actions by adhering to corporate values.

- Respect
- Integrity
- Courage
- Collaboration

WE CREATE NATURAL FIBER...

Our Locations



● Industrial Presence

Forests

- Argentina
- Brazil
- Chile

Wood

- 3 Sawmills
Mulchén, Nacimiento and Bucalemu
- 2 Millwork Mills
Coronel and Los Ángeles
- 1 Plywood Mill
Collipulli

- 2 Millwork Mills
Jeffersonville, KY
Clay City, KY

Pulp

- 3 Mills
Laja, Santa Fe and Pacífico
- 1 Mill
Guaíba

● Commercial Presence

- Santiago
- Los Ángeles
- Guaíba
- Georgia
Kentucky
- Shanghai
- Hamburg

Forest Heritage

In 2022, the company's forest assets totaled 3,286,217 acres. Approximately 69% of this land is dedicated to the production of pulp, wood products, and other fiber-derived goods. The remaining 31% is allocated for purposes such as protection, conservation, and other non-forestry and agricultural uses.

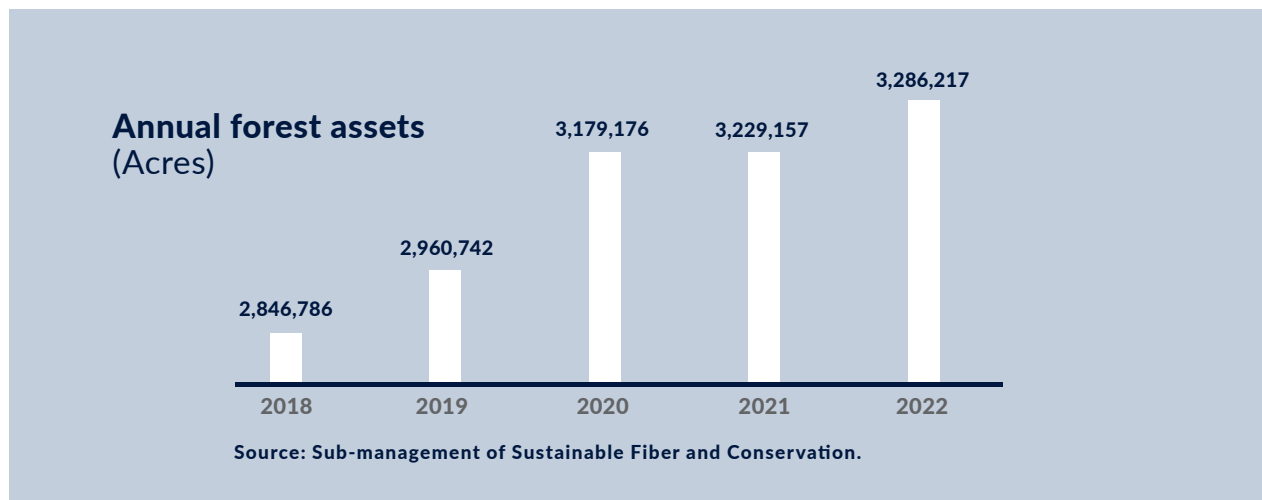

CMPC's main commercial species depend on the country in which they are produced:

- **Argentina:** Pinus taeda and Pinus elliotti
- **Brazil:** Eucalyptus saligna, Eucalyptus grandis, and hybrid varieties of eucalyptus
- **Chile:** Eucalyptus globulus, Eucalyptus nitens, Pinus radiata, and hybrid varieties of eucalyptus

The main products generated by CMPC's forests are logs (Chile, Brazil, and Argentina) and chips (Chile).



Nurseries

Everything begins in our nurseries: it's the foundation of our work. We cultivate more than 40 million plants to form new forests, employing a rigorous approach for seed selection and genetic enhancement. This results in trees with optimal attributes like shape, height, and structure.

With the same patience and precision found in nature, we cultivate high-value plantations that yield profitable, sustainable, and certified wood. In our Radiata Pine forests, we maintain the health of trees and produce top-quality, knot-free wood through meticulous thinning and pruning.

The forest production cycle has five stages that span across 3 areas:

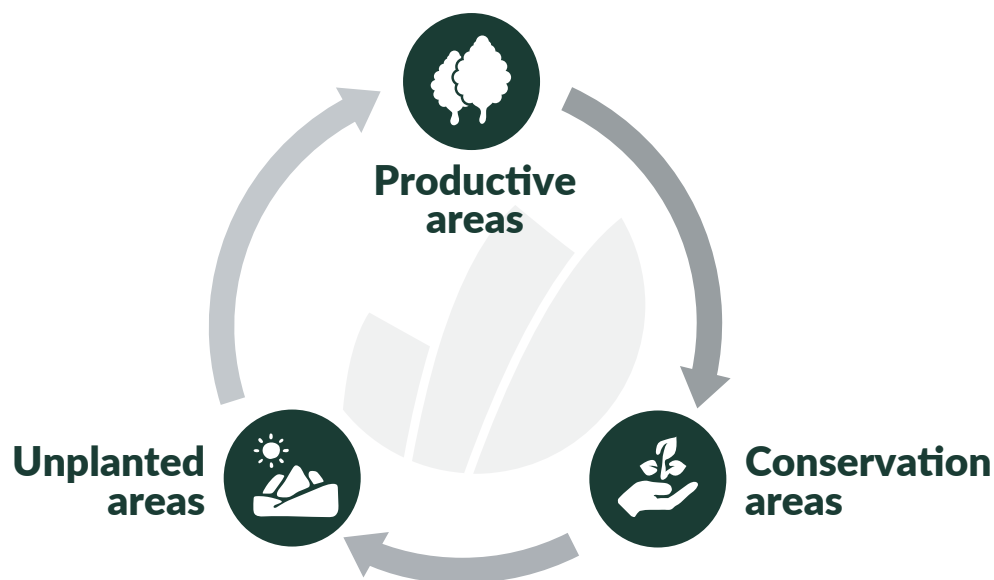

Stage 1—Genetic Material Selection and Production: This involves the careful selection and cultivation of genetic material for plant production in incubators.

Stage 2—Establishment: This encompasses the preparation of land, setting up the space, and the planting of forest stands.

Stage 3—Silvicultural Management: This primarily includes pruning and thinning interventions to promote healthy growth and development.

Stage 4—Forest Harvest: Harvesting takes place when the forest reaches maturity.

Stage 5—Transportation: This involves the shipment of products, such as rolls and chips, to consumption centers.

Forest Management

At CMPC, the sustainable management of forest crops is a fundamental pillar of our commitment to sustainable profitability, achieving harmony among the benefits to society, the economy and the environment.

Sustainable forest management involves achieving and maintaining long-term certifications. These certifications increase the economic, social, and environmental value of the forest through policies, standards, and procedures. These measures allow for the protection, monitoring, and care of the forest, ultimately benefiting various local actors and ecosystems.

Although certification is voluntary, companies are encouraged to willingly engage in and undergo audits that certify compliance with its requirements. This allows customers and consumers to know and analyze the traceability of the purchased fiber and ensure that their products are not obtained from controversial sources.

This is why all CMPC operations meet the highest standards of forest management, which are certified by FSC® and CERTFOR-PEFC™ to guarantee the protection of the native forest and biodiversity, thus ensuring harmonious operations in the economic, social, and environmental sectors.

Sustainable Heritage

98.3% of CMPC's total forest assets are certified.

Forest heritage	2021		2022	
	FSC®	PEFC™	FSC®	PEFC™
Owned and certified	-	-	1,069,126	985,850
Leased and certified	-	-	210,817	188,226
Forest assets certified by certifying agency	971,532	986,037	1,279,943	1,174,076
Total certified forest assets	1,087,376	1,087,376	1,307,647	1,307,647
Percentage of total certified assets	89.3%	90.7%	97.8%	89.7%
Total forest assets	1,307,351	1,307,351	1,329,885	1,329,885
Percentage of total certified forest assets	74.3%	75.4%	96.2%	88.3%

Source: Sub-management of Sustainable Fiber and Conservation.

Note 1: The real certified forest assets pertains to the total set of certifying agencies as well as the area with only one of them.

Note 2: The total certified forest assets are calculated based on the total forest assets. The percentage concerning the certified assets is used to calculate the percentage per certifying agency against the total certified.

An aerial photograph showing a large log boom on a river. The boom is composed of many parallel logs stacked together, forming a long, narrow structure. A tugboat is visible in the center of the boom, pushing it along the river. The water is a deep blue color, and the logs are a natural brown color. The perspective is from directly above, looking down at the boom.

CMPC WOOD PRODUCTS

Plants

CMPC Maderas is the business unit within CMPC dedicated to enhancing the value of the group's forest legacy through the production and marketing of wood products.

We operate six plants in southern Chile, each dedicated to upholding rigorous standards in occupational health and safety across all facets of our operations.

Production Capacity

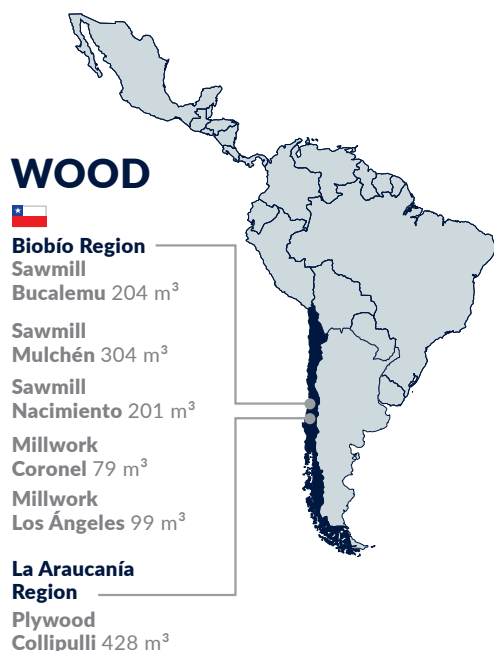

Plywood



Boards and Mouldings



Sawn Timber

MILLS

PLYWOOD MILL

Located in the town of Collipulli, in the Araucanía Region, our plywood mill is the world's largest plywood mill under a single roof with a production capacity of more than 9,000 trucks per year.

SAWMILLS

Located in the Chilean towns of Bucalemu, Mulchén, and Nacimiento, our sawmills have a production capacity of more than 20,000 trucks per year.

MILLWORK MILLS

Located in the cities of Los Ángeles and Coronel, our millwork mills have a production capacity of more than 4,800 trucks per year, using advanced technology that meets the highest quality standards.

Millwork

Our CMPC Radiata pine and poplar, finger-joint blanks, mouldings, trimboards and specialty products are known for their high quality and versatility. They exhibit excellent dimensional stability and possess the ideal density, making them incredibly easy to work with and ensuring their optimal utility in a wide range of projects.

CMPC's finger-joint blanks, mouldings, trimboards and specialty products embody our commitment to quality and meticulous craftsmanship, reflecting the dynamic spirit of our company. We consistently strive to provide solutions that showcase the finest attributes of wood in diverse decorative and construction projects worldwide—a choice that truly sets us apart.

Bring your vision to life!
*We can convert your idea
into new products.*

Turn your concept into reality.

We offer custom-made mouldings.

Thickness:

9/16, 11/16: 23/32, 1 1/8

Mouldings Width:

2 1/4 - 5 1/2 and specialties over 5 1/2 to 7 1/2

Primed Boards Width:

2 1/2 to 11 1/4

Raw Boards Width:

up to 35"

Share your ideas with us

 www.cmpcmaderas.com

 cmpcusa@cmpc.cl

 www.pvmillwork.com

 [cmpc-maderas](https://www.linkedin.com/company/cmpc-maderas)

 (770) 551-2640

PRODUCTS

We offer FJ Blanks, Trimboards, Mouldings and Specialty custom-made products in Radiata Pine, Poplar and Taeda.



TRIMBOARDS



Products

IT ALL BEGINS WITH A SEED... that transforms into a resilient and noble material. Building is a process of imagination, pushing the limits of what is possible. At CMPC Maderas, we are building the future. That's why all CMPC products come from our own plantations that have been carefully cultivated to achieve top-quality wood.

TRIMBOARDS

Selex® Trimboards are defect-free, extraordinarily versatile finger-joint boards with medium density and a uniform texture. These panels have excellent workability properties, nail clamping, crack resistance, and dimensional stability. Also, by having the Selex® seal, they deliver our guaranteed manufacturing excellence through technology and rigorous production processes that ensure our high product standards.

GENERAL CHARACTERISTICS

- **Density:** Between 400 to 480 kg/m³
- Non-structural polyvinyl acetate (PVA) adhesive that has high performance with excellent results on porous substrates
- Up to 3 coats of matte gloss primer at a 60-degree angle
- Carbonization rate of 7mm/min

Painted

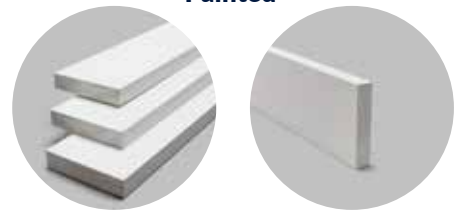

Natural

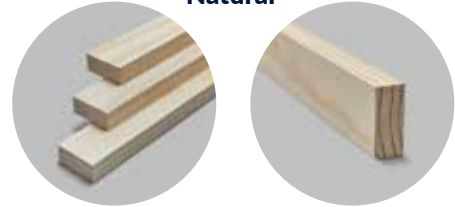

SIZE	REAL	Length (ft)
1" x 4"	23/32 x 3 1/2	8' 12' & 16'
1" x 6"	23/32 x 5 1/2	8' 12' & 16'
1" x 8"	23/32 x 7 1/4	8' 12' & 16'
1" x 10"	23/32 x 9 1/4	8' 12' & 16'
1" x 12"	23/32 x 11 1/4	8' 12' & 16'

SIZE	REAL	Length (ft)
5/4" x 4"	1 1/8 x 3 1/2	8' 12' & 16'
5/4" x 6"	1 1/8 x 5 1/2	8' 12' & 16'
5/4" x 8"	1 1/8 x 7 1/2	8' 12' & 16'
5/4" x 10"	1 1/8 x 9 1/2	8' 12' & 16'
5/4" x 12"	1 1/8 x 11 1/2	8' 12' & 16'

*Available in other thicknesses, widths, and lengths



PRIMER

- A water-based latex primer for both interior and exterior use, depending on the requirements.



FINISHES

- Natural and/or primed, in addition to gesso and primed variant.

MAIN USES

- Interior
- Exterior
- Wall paneling applications

MOULDINGS

CASINGS



MOULDINGS

Our mouldings, made of Radiata Pine with finger joints, are an extraordinarily versatile product with exceptional dimensional stability. They have excellent workability properties and are designed to be used for construction, decorative finishes, ceiling-wall joints, doors, and windows such as cornices, dust covers, and pilasters.

Casings



Profile: STF 1



Profile: WC1CT

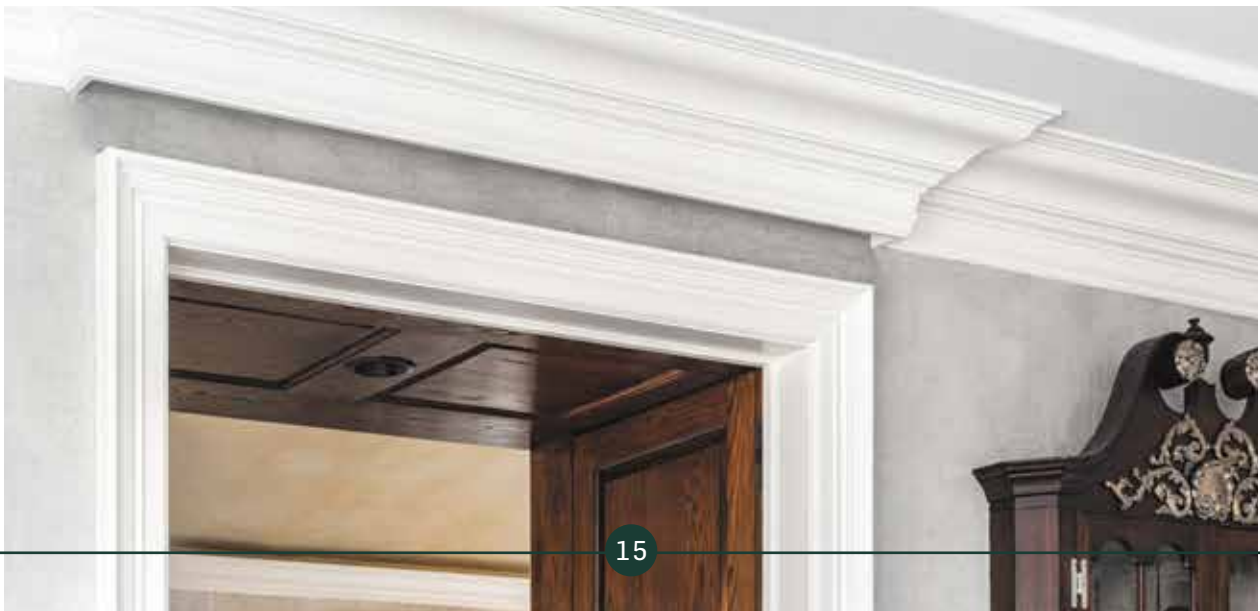
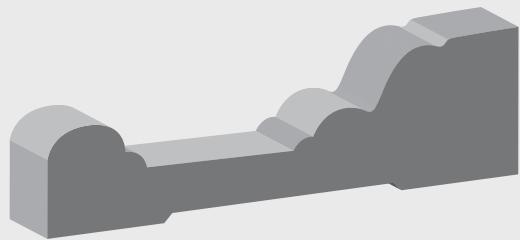

Casings

Profile: WM 361

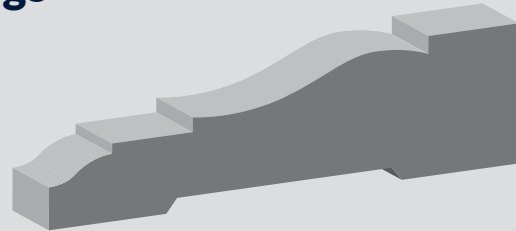
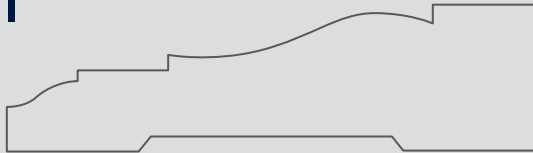

Profile: WM 366

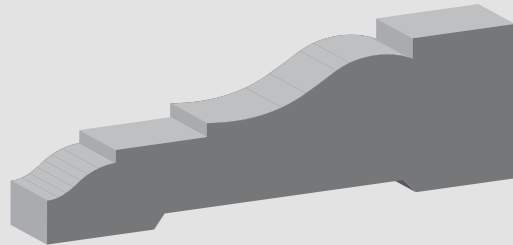
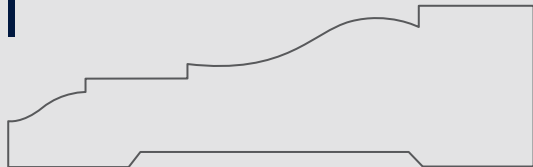

Profile: WM 442

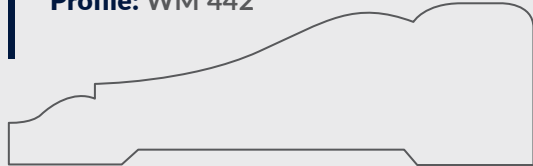

Profile: WM 376

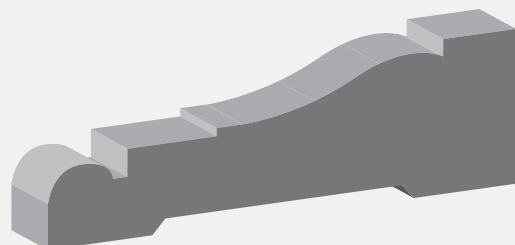
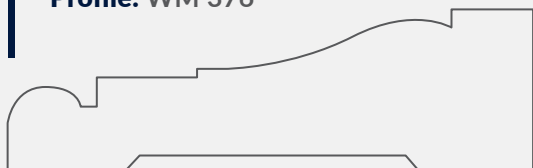

Casings

Profile: WM 327

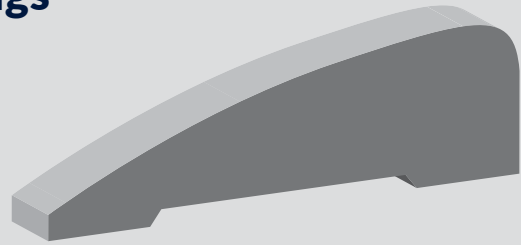
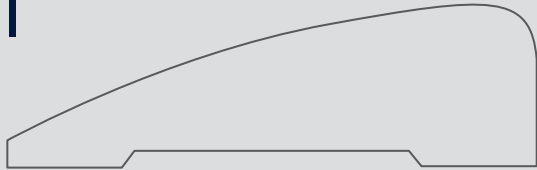

Profile: WM 445

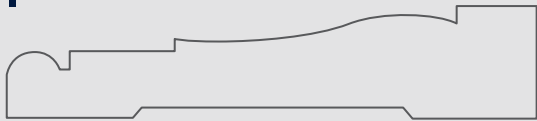

Profile: WM 351

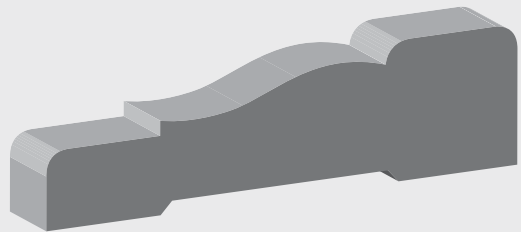
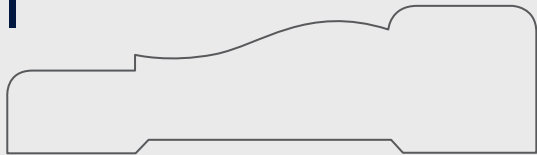

Profile: WM 356

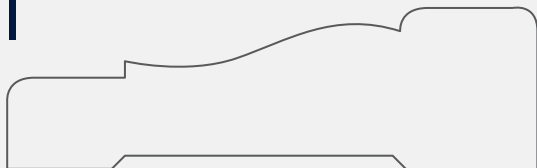

MOULDINGS

BASE BOARDS



Base Boards



Profile: 5180 BASE

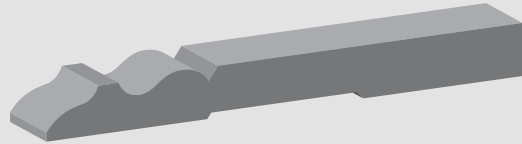

Profile: BB7

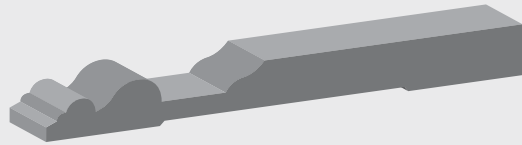

Profile: BB6

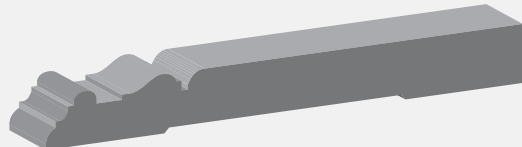

Profile: BB 514=E 163



Base Boards

Profile: WM 663

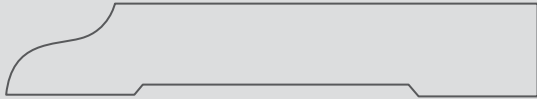

Profile: WM 753

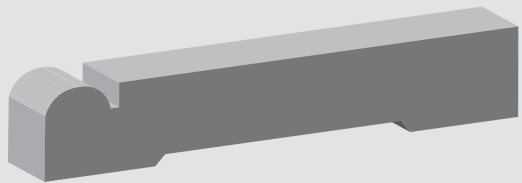
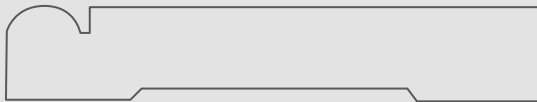

Profile: WM 618

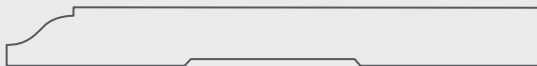

Profile: WM 713

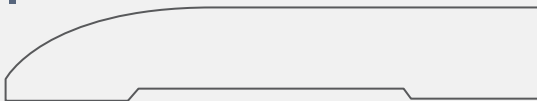

Base Boards

Profile: WM 750

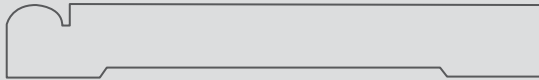

Profile: WM 662

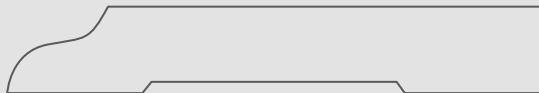

Profile: WM 623

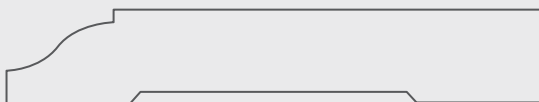

Profile: WM 620



MOULDINGS CROWNS



Crowns

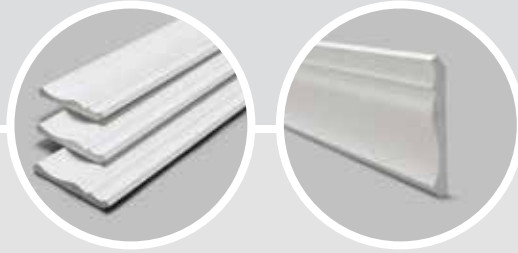

Profile: COVE 4.1/2"

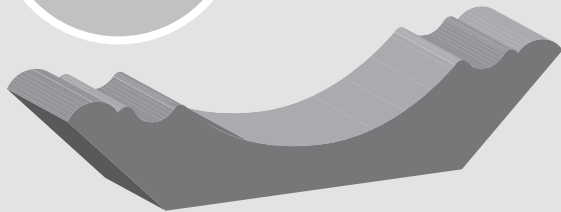
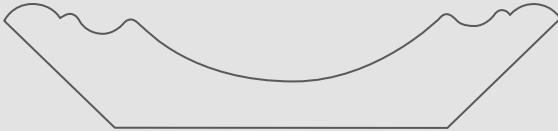

Profile: COVE BC5

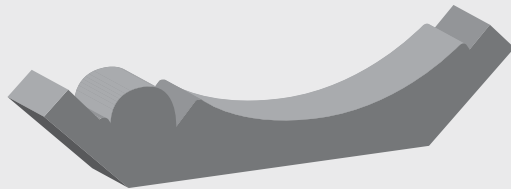
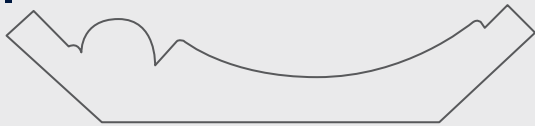

Profile: LWM 47



Profile: LWM 49



Profile: UC51



Attributes and Main Uses

Primer

Water-based latex primer suitable for interior and exterior use

Finishes

- Raw
- Single-primed, double-primed, or triple-primed available in addition to gesso and primed variant
- Matte or glossy finishes available

Main Uses

- Doors
- Ceiling-Wall Joints
- Windows
- Cornices
- Dust Covers
- Pilasters
- Furniture
- Construction



Specialties

CMPC Wood Products boasts a line of high-tech remanufacturing specialties with exhaustive quality control, allowing for value-added products that offer comprehensive and versatile solutions for diverse requirements.

SHIPLAP

CMPC Shiplap is made from high-quality, sustainably managed Radiata Pine lumber. It is finger-jointed, extremely versatile, and easy to install, as the product is pre-primed in a vacuum chamber at the manufacturing facility. It comes in highly finished straight and smooth pieces, ideal for interior finishes and wall paneling with great visual appeal.

- Clear Radiata Pine fiber
- Two-Coat finish: white latex primer suitable for exterior use
- Double polishing to achieve a smooth finish and texture
- Controlled drying system for greater adhesion of the latex coatings
- Quality control that ensures consistency in the thickness tolerance
- Using micro finger-joint results in a larger contact surface and tighter joints, creating greater structural resistance

Available sizes

1 x 4 (3/4 x 3-1/2)	1 x 6 (3/4 x 5-1/2)	1 x 8 (3/4 x 7-1/4)
---------------------	---------------------	---------------------

General Specifications	
Adhesive	Non-structural exterior grade Cross-Linking PVA (Polyvinyl Acetate)
Primer	100% water-based acrylic coating applied in the factory
Finishing	Front sanding (120-180 grit) and Polishing (600 grit). Shiplap profile
Forest Certification	FSC® certified products





EDGE & CENTER

This product is made from high-quality, sustainably managed Radiata Pine lumber. It is finger-jointed, extremely versatile, and easy to install, as the product is pre-primed in a vacuum chamber at the manufacturing facility. It comes in straight and smooth pieces, ideal for horizontal, vertical, or diagonal finishes and decorative end uses.

- Clear Radiata Pine fiber
- Two-Coat finish: white latex primer suitable for exterior use
- Double polishing to achieve a smooth finish and texture
- Controlled drying system for greater adhesion of latex coatings
- Quality control that ensures consistency in thickness tolerance
- Using micro finger-joints results in a larger contact surface and tighter joints, creating greater structural resistance

Available sizes

1 x 4 (9/16 x 3-1/2)	1 x 6 (3/4 x 5-1/2)
----------------------	---------------------

General Specifications

Adhesive	Non-structural exterior grade Cross-Linking PVA (Polyvinyl Acetate)
Primer	100% water-based acrylic coating applied in the factory
Finishing	Front sanding (120-180 grit) and Polishing (600 grit). Edge and Center Bead profile
Forest Certification	FSC® certified products

TREATED TRIMBOARD

Milex® Radiata Pine Treated Trimboards are manufactured based on a finger-joint system, free of defects, with excellent aesthetic quality. The trimboards boast exceptional mechanical and physical resilience, as well as remarkable moisture resistance. Each board is finished with two coats of exterior latex primer that are applied in vacuum chambers, giving each board the highest aesthetic quality available.

In addition, our panels come with an impregnation treatment (tebuconazole, propiconazole and permethrin from Koppers company) that provides excellent durability.

Milex® Radiata Pine Treated Trimboards are offered in different sizes in thickness, width, and length to meet your needs and those of your customers.

- Excellent visual finish for immediate installation
- Protection against rot, termites, and fungi
- Exceptional resistance to outdoor environments
- Safe for indoor use
- Environmentally friendly treatment
- Protected to the core of the product
- Great looking knotless pieces

Available sizes

Size (NOMINAL)	Real	Length (ft)
1" x 4"	23/32 x 3 1/2	8' 12' & 16'
1" x 6"	23/32 x 5 1/2	8' 12' & 16'
1" x 8"	23/32 x 7 1/2	8' 12' & 16'
1" x 10"	23/32 x 9 1/2	8' 12' & 16'
1" x 12"	23/32 x 11 1/2	8' 12' & 16'

Size (NOMINAL)	Real	Length (ft)
5/4" x 4"	1 1/8 x 3 1/2	8' 12' & 16'
5/4" x 6"	1 1/8 x 5 1/2	8' 12' & 16'
5/4" x 8"	1 1/8 x 7 1/4	8' 12' & 16'
5/4" x 10"	1 1/8 x 9 1/4	8' 12' & 16'
5/4" x 12"	1 1/8 x 11 1/4	8' 12' & 16'

NICKEL GAP

This product is made from high-quality, sustainably-managed Radiata Pine lumber. It is finger-jointed, extremely versatile and easy to install, as the product is pre-primed in a vacuum chamber at the manufacturing facility. It comes in straight and smooth pieces, ideal for horizontal, vertical, or diagonal finishes and decorative end uses.

- Clear Radiata Pine fiber
- Two-Coat finish: white latex paint for outdoor use
- Double polishing to achieve a smooth finish and texture
- Controlled drying system for greater adhesion of latex coatings
- Quality control that ensures consistency in the thickness tolerance
- The use of micro finger-joints creates a larger contact surface, tighter joints, and therefore, higher structural resistance



Available sizes

Size (NOMINAL)	Real	Length (ft)
1" x 6"	23/32 x 5 1/2	8' 12' & 16'
1" x 8"	23/32 x 7 1/2	8' 12' & 16'

Size (NOMINAL)	Real	Length (ft)
5/4" x 6"	1 1/8 x 5 1/2	8' 12' & 16'
5/4" x 8"	1 1/8 x 7 1/2	8' 12' & 16'

General Specifications

Adhesive: Non-structural adhesive Cross-Linking PVA (Polyvinyl Acetate) of exterior grade

Painted: 100% water-based acrylic coating applied at the factory

Finishes: Front sanding (120-180 grit) and Polishing (600 grit)

Forest Certifications: FSC® and PEFC™ certified products

New Milestones

We are very pleased to share with you another important milestone in our history. CMPC has recently acquired Powell Valley Millwork.



Benefits

- Provides tremendous growth opportunities
- Market expansion
- Improvements to our current product offering
- Strengthens our market position
- Complements our product mix
- Improves our response time
- Delivers a better level of service to our clients—a fundamental pillar of our 2030 strategy

This strategic decision not only drives our expansion, but also guarantees the sustainability of our business over time.

Meet Powell Valley Millwork

Family-owned and operated in the heart of the Appalachian forest, Powell Valley Millwork is a domestic manufacturer of Poplar millwork that specializes in creating the highest quality Poplar wood products. With two manufacturing sites conveniently located just east of Lexington, Kentucky, more than two-thirds of the US population is easily accessible within a day's drive.

Powell Valley Millwork proudly employs approximately 200 hard-working Kentuckians to operate 320,000 square feet of manufacturing and warehouse space, where Poplar products come to life. Focused on remanufacturing, Powell Valley Millwork is a leader in creating primed finger-joint interior trim. The team at Powell Valley Millwork is accessible, dependable and focused on exceeding customer expectations.

Poplar

The Poplar species is one of the largest trees in the US Forest and can produce very wide and long specifications, which are relatively knot free. It represents around 9% of the standing hardwood resource, which ensures continuity and volume supply to both domestic and export markets.

When it comes to durability, value, warmth, quality, and overall appearance, there is simply no alternative for genuine Real American Hardwood. Hardwood's natural beauty, desirability and lifetime value can be imitated, but never replicated.

For centuries, American hardwoods like Poplar have been admired for their lasting beauty and sought after because of their milling quality and durability in the home or office.

Known as the painter's wood, Poplar dries easily with minimal movement in performance and machines to a smooth finish taking paint and stain exceptionally well. Finally, domestically-manufactured hardwood allows for improved service and inventory flexibility.

Products

Primed Moulding and Trimboards

Elegant moulding profiles and trim make a house into a home. Unlike other options for interior trim, Poplar is a hardwood bringing crisp and definitive lines while painting smooth for a lasting durable finish in the home or office. Our profile library expands into thousands of different SKUs with varying designs, thicknesses, widths, and lengths.

Our state-of-the-art facilities produce primed or raw, solid or finger-jointed mouldings, jambs, and S4S boards in truckload quantities to ship anywhere in the world.

Door and Window Jambs

The strength of a quality door is only as good as the frame that supports it. We produce a variety of flat jambs, rabbeted frames, as well as the headers and stop to accompany these components. Utilizing 100% Poplar, our door components bring strength and functionality that other substrates lack in the marketplace. Customers can order in a variety of widths ranging from 4 5/8" through 11 1/4" with end work capabilities including DADO and PET.





Interior Shutter Components

Custom window treatments that accent the architectural design of a home are not just a beautiful addition, they are functional as well.

Home builders and design professionals recognize the need for high quality materials and craftsmanship in their shutter components to provide a superior product that will last for generations.

Our entire manufacturing process is predicated upon the rigorous standards of the shutter industry. A blind treatment, by its very nature, is seen on all four sides with constant light flowing over it. We produce all our Poplar mouldings to meet these standards and often exceed them.

Picture Frame Mouldings and Stretcher Bars

Our hardwood products are moulded from the same kiln-dried Poplar we use in plantation shutter components guaranteeing stability and dimensional accuracy. Benefits include:

- 100% utilization of the moulding end-to-end, meaning no more yield loss with defects or inadequate material
- Straighter, flatter, and more durable than other substrates
- Accepts paint, stain, paper, and vinyl better than other materials
- Easily supplied in full truckloads or in single unit quantities
- Profile wrapping and mitering capabilities available
- Proudly made in the USA with as little as 2-3 weeks lead time

Unlike other materials, our solid wood products can be stained and the finger-jointed stock may easily be painted. Because it is a kiln-dried hardwood, it takes nails and staples well and will not warp with age like pine. Poplar is often called painter's wood because of its soft, smooth finish and durability.



Finger-Joint Poplar Moulder Blanks

For those customers operating their own moulding equipment, we offer a variety of moulder-ready blanks in 4/4, 5/4, and 6/4 thicknesses with lengths ranging from 8' to 20' in length. Our blanks are clear four sides and are produced utilizing a horizontal joint.

At each of our five finger-jointers, we test regularly for joint integrity and maintain stringent quality control parameters to ensure quality and durability.

Additionally, we have partnered with the Department of Sustainable Biomaterials at Virginia Tech to perform strength evaluations on our material. Our customers across North America can rest assured that our finger-joint material is rigorously tested for durability.

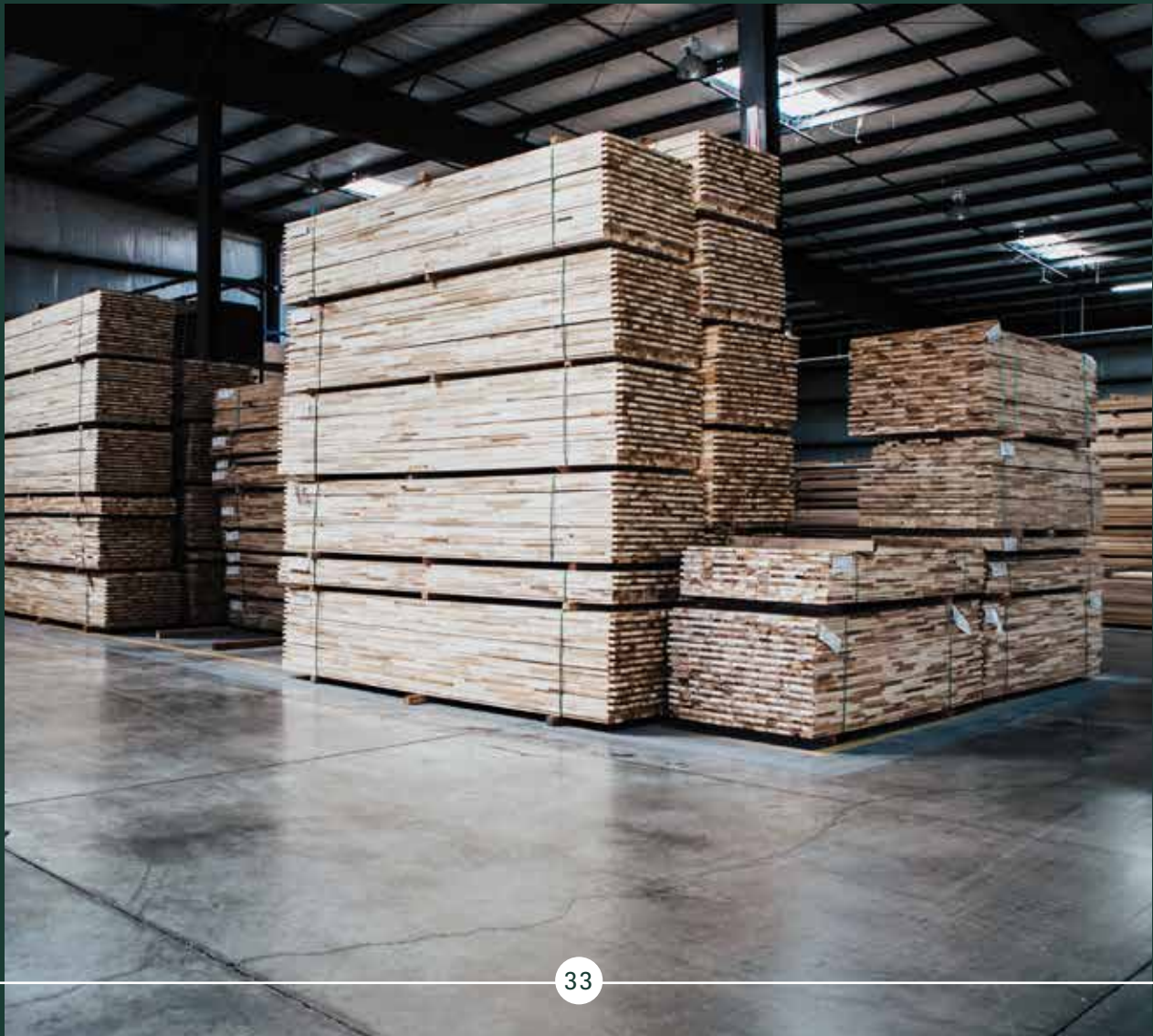

FAQ

WHAT IS THE RAW MATERIAL FOR TRIMBOARDS AND MOULDINGS?

Our products are manufactured from Pinus Radiata (D. Don), commonly known as Radiata, Insignis, or Monterey Pine. The species has chestnut heartwood and white-yellowish sapwood along with a fine, uniform texture.

WHAT TYPE OF ADHESIVE IS USED ON FINGER-JOINT PANELS?

A non-structural adhesive made of polyvinyl acetate (PVA) is used, delivering outstanding performance, particularly on porous substrates, with excellent results. The adhesive is tested by Canada Wood using the JIS A 1460 method and certified by IFT Rosenheim (Germany) to pass durability class D4 according to DIN EN 204.

WHAT TYPE OF PRIMER IS USED?

The primer used is 100% acrylic water-based, allowing broad compatibility with oil-based and water-based solvent products.

HOW MANY COATS OF GLOSS ARE APPLIED?

More than 3 coats of matte gloss are applied at a 60 degree angle based on ASTM D523 standards.

CAN THE TRIMBOARDS BE USED OUTSIDE?

Yes, but be sure to apply paint that is guaranteed for outdoor use and that all edges are sealed.

WHAT TYPE OF PAINT IS RECOMMENDED FOR OUTDOOR USE?

Both, latex and acrylic paint can be used.

HOW MANY COATS OF PAINT ARE RECOMMENDED FOR THE TRIMBOARDS?

We recommend applying at least 2 coats of paint.

IS THERE A SYSTEM TO MONITOR PRODUCT QUALITY?

Yes, the plant has implemented routine quality controls to ensure wood adhesion in accordance with ASTM D 3359 and ASTM D 4541 standards. Controls are also carried out to ensure optimal thickness measurement according to ASTM D 6132 standard.

HOW DO THE TRIMBOARDS REACT TO FIRE?

They have a carbonization rate of 7mm/min.



CMPC + Powell Valley Millwork Fast Facts



12

Countries with Industrial & Commercial Presence



48

Industrial Plants



100+

Years of History



22,000+

Employees



Stay connected by following us online today:

cmpc.com

cmpcmaderas.com

cmpcusa@cmpc.cl

[@vidaenmadera_](https://www.instagram.com/vidaenmadera_)

[CMPC Maderas](https://www.linkedin.com/company/cmpc-maderas)

pvmillwork.com

[Powell Valley Millwork](https://www.facebook.com/PowellValleyMillwork)

[@powellvalleymillwork](https://www.instagram.com/@powellvalleymillwork)

[Powell Valley Millwork](https://www.linkedin.com/company/PowellValleyMillwork)